

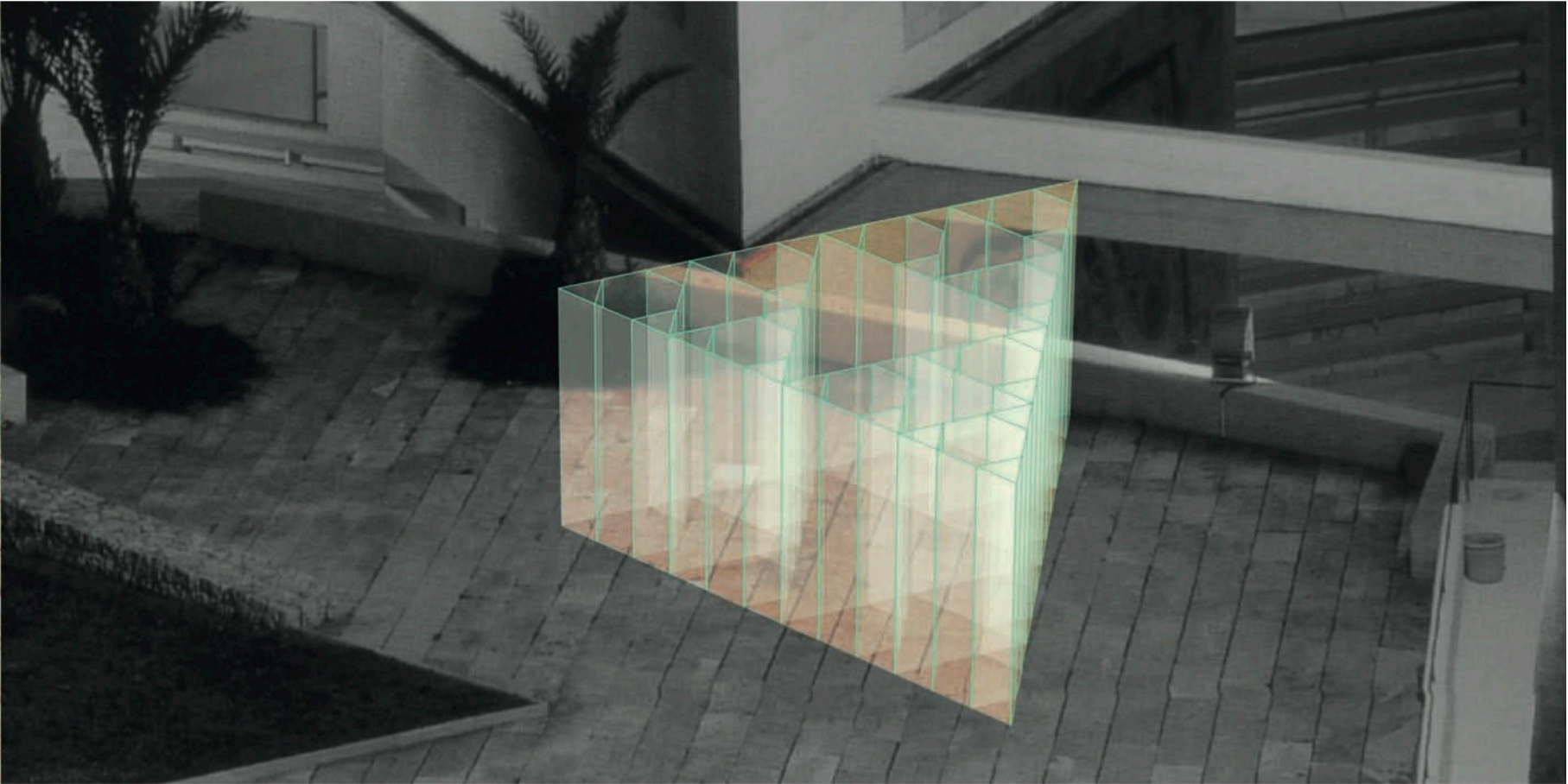

serdica triangles - sculpture terrace and palm tree terrace moneo building area, pilar i joan miró a mallorca foundation, mallorca
spain 2013 design: jan doms | visualisation: ir. philip van boxtel | principal: sant marc and joan miró a mallorca foundation

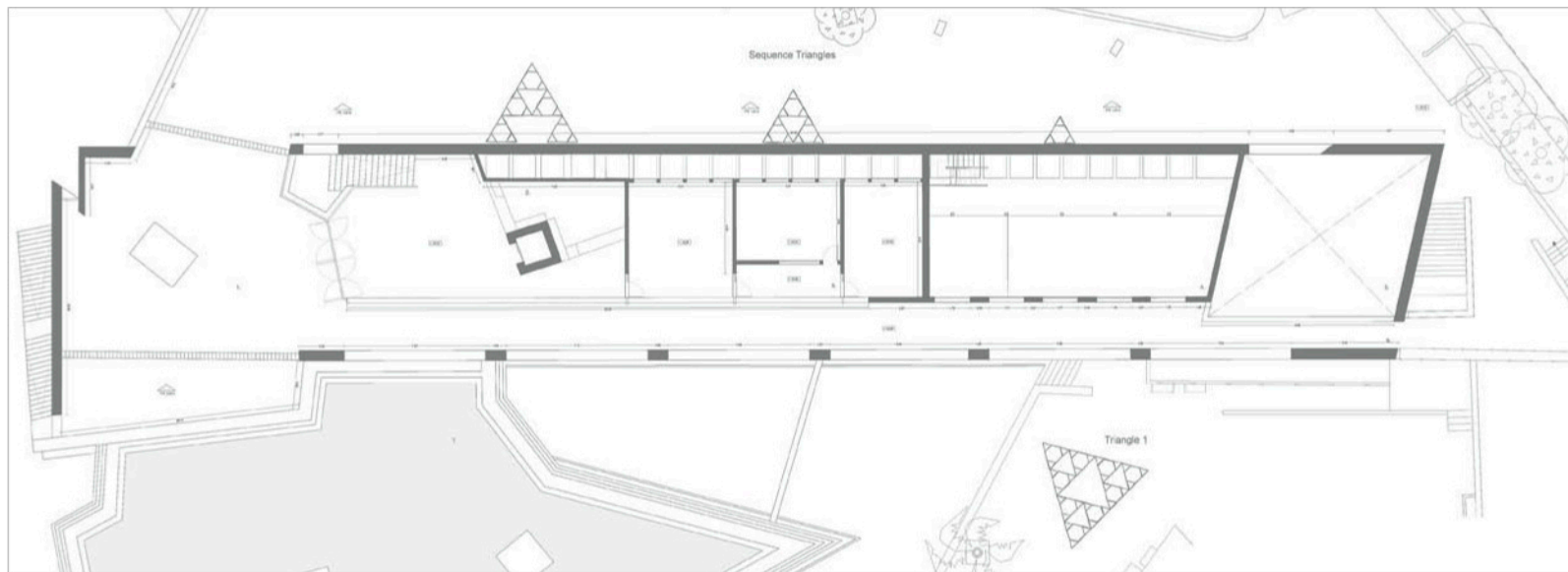

the initial inspiration for the **serdica triangles** were the triangular fortifications that are part of the roman remains in sofia. in this case the triangles are adapted to the idiom of the architect of the miró museum, rafael moneo.



plan area and position of triangles

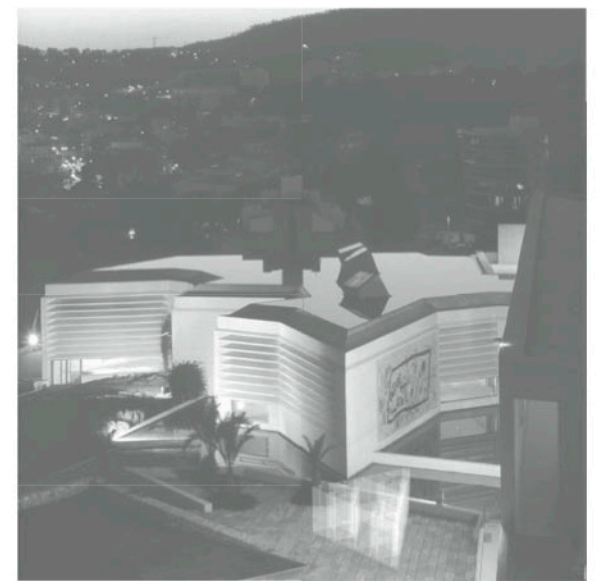

overview area